



Great Marsh

A waterfront retreat! Set back off a private road in desirable Saugatuck, this Colonial presides over lush, manicured grounds with a pool. Its open floor plan features expansive vaulted living spaces flooded with natural light. Walk or bike to the beach, take advantage of a short cut to the Saugatuck Yacht Club or simply relax poolside and enjoy water views from your private oasis along Long Island Sound.

MICHELLE & COMPANY

Your Life 🏡 Your Home 🏡 Your Realtor

203.454.HOME | 203.454.4663

michelleandcompany.com

WILLIAM RAVEIS
EXCEPTIONAL PROPERTIES

Welcome to Great Marsh

*A generous lawn spreads before the
home and open water beyond.*

Enter beneath a leafy canopy of flowering fruit trees on an admiring approach along the expansive front lawn towards an ideal American Colonial. A red door beneath a stately portico creates a handsome focal point in its façade featuring sunny bay windows framed by shutters. A spacious traditional foyer with hardwood floors creates a warm welcome and only hints at the remarkable rooms still to be revealed.





A sun and water lover's retreat.

Enjoy coffee after dinner admiring the sunsets framed by a bay window of this beautiful formal living room — that is if you can entice your guests to leave the dinner table. Set in spectacularly sunny spaces such as the sunroom, the eat in kitchen or the expansive vaulted dining room with floor to ceiling windows, everyone may linger at the table savoring the views long after the meal is finished.





Soaring ceilings throughout a spacious open plan.

Hand painted tiles adorn the surfaces of this charming eat-in kitchen. Its spacious open plan impresses the moment you enter from the foyer, ahh, but there's so much more in store. Flooded with natural light, the vaulted family room with its towering west wall of glass formed by custom windows raises the bar to new heights.





Masterful views from every room!

A sunny perch on a raised area in the vaulted great room creates a cozy seating area. A spiral stair leads to a finished lower level and even more entertaining space. With such large living spaces and this ideal setting, Great Marsh is certain to be the choice destination for holiday gatherings with the whole family.

Each bedroom enjoys wide windows and views of this lovely setting. All are equally spacious and one has an en suite bath.

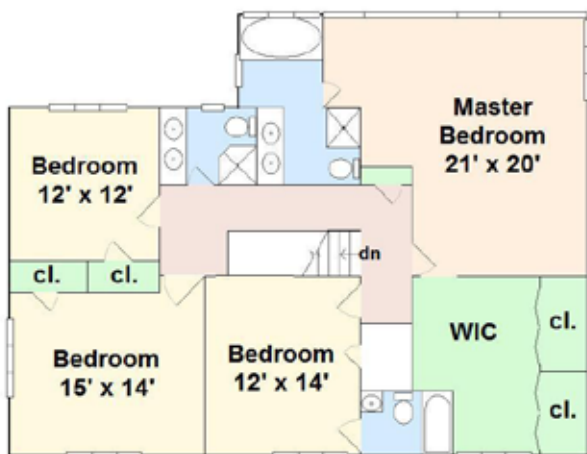



A master suite that makes each day feel like a vacation.

In addition to walls of windows with romantic water views, this vaulted master enjoys a spacious dressing room with his and her closets and a marble tiled master bath with its spa tub perfectly situated below a picture window. Wake each morning with the sun rising over LI Sound and return each evening to the soft, lulling sound of boats rocking on the water.





Style:	Colonial
Acres:	1.11+/-
Year Built:	1967
Square Feet:	4,828+/-
Rooms:	12
Bedrooms:	5
Baths:	5 Full/1 Half
Heating:	Oil/CA
Garage:	2
Sewer & Water:	Septic, City Water
Exterior Features:	Pool, Hot Tub, Patio, Sprinkler, Lighting



MICHELLE & COMPANY

Your Life 🏡 Your Home 🏡 Your Realtor

203.454.HOME | 203.454.4663

m i c h e l l e a n d c o m p a n y . c o m

WILLIAM RAVEIS
EXCEPTIONAL PROPERTIES